

b **2 Channels**

b **Ball Bearings**

b **100,000,000 Cycles**

b **50, 100, 200, 250 PPR**

b **Robust Construction**

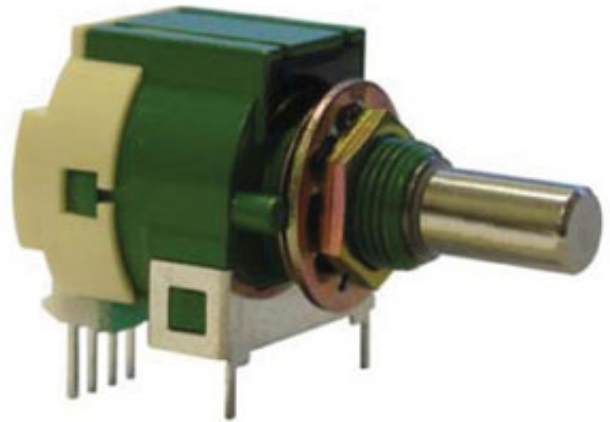

The M111 incremental encoder is characterized by high resolution (up to 250 PPR) and very long life (one hundred million cycles). Rugged design features aluminum housing, metal shaft and ball bearings making it ideal for applications where a high quality encoder with long life is required.

Electrical Specifications	M111
Resolution	50, 100, 200, 250 PPR
Channels	2 (A,B)
Frequency Response	500 Hz max.
Supply Voltage	5 VDC \pm 5%
Current Consumption	26mA nominal, 30mA max.
Output Voltage	High: 4.2V min. Low: 0.4V max.
Mechanical Specifications	
Rotational Life	100,000,000 cycles
RPM	up to 600 max.
Starting Torque	50 gf-cm max.
Shaft Loading	1.0 kgf (Radial and Axial)
Weight	28 grams
Environmental Specifications	
Operating Temperature	0°C to +60°C
Storage Temperature	-20°C to +80°C
Humidity	85% RH, no condensation
Vibration	10 - 55 Hz, 1.5mm, 2 hrs.
Shock	50G, 6ms, 3 axes, 3 reps
Protection Grade	IP 40
Materials	
Housing	Aluminum
Shaft / Bushing	Metal

Schematic

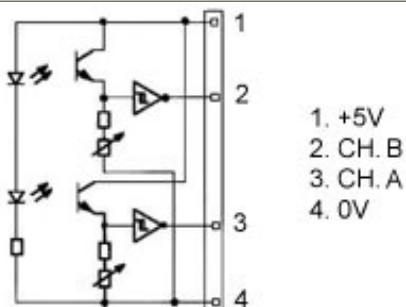

Output Waveform

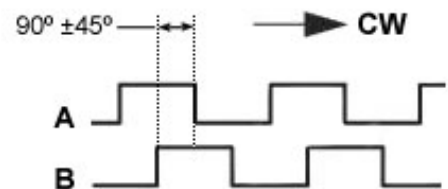

Dimensions (mm)

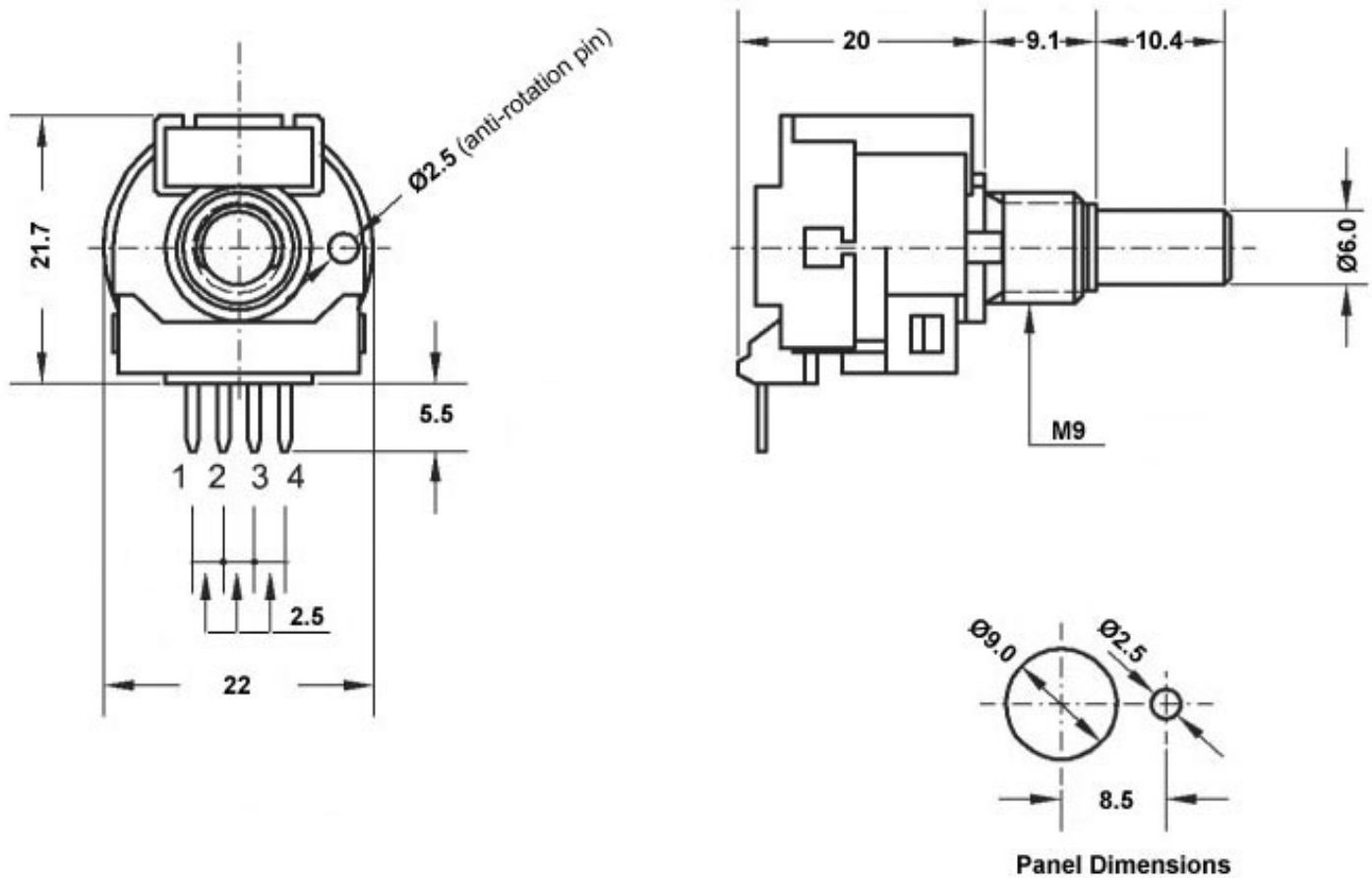

P3 America
3089C Clairemont Dr. #363 - San Diego, CA 92117
Phone: (858) 277-1420 Fax: (858) 225-0439
www.p3america.com

© P3 America 2004. All Rights Reserved