

Contactless



- **> 50 Million Turns Rotational Life**
- **Small Dimensions**
- **Infinite Resolution**
- **1.5% Linearity**

Compact (13mm diameter) hall effect sensor features high precision and very long life. Ideal for high duty cycle applications. Also ideal where sensor stays in one position for extended periods, such as throttle controls.

Electrical Specifications	
Electrical Angle	$\pm 45^\circ$ (90°)
Input Voltage	5 VDC $\pm 10\%$
Linearity Tolerance	$\pm 1.5\%$
Temperature Drift (Vout)	$\pm 2.5\%$ (full stroke) / $\pm 0.5\%$ (center position)
Current Consumption	6 mA
Resolution	Infinite
Load Resistance	> 100k ohm
Output vs. Input	10% - 90% (0.5V to 4.5V)
Mechanical Specifications	
Mechanical Angle	360° (continuous)
Max. Rotational Speed	40 rpm
Max. Operating Torque	< 0.2 (Ncm) / 0.5 to 1.5 (Ncm) with O-ring (IP65 version)
Life Expectancy	> 50,000,000 turns
Bearing	sleeve bearing
Environmental Specifications	
Operating Temperature	-40°C to +105°C
Protection Grade	IP40
Materials	
Housing, Bushing	Metal
Shaft	Stainless steel
Wire Leads	AWG26, 3x, 150mm long

Dimensions (mm)

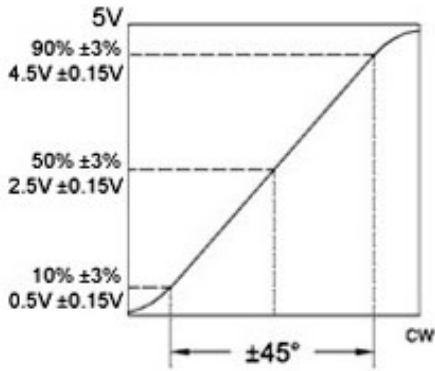

Output is 2.5V (50%) when shaft flat and bushing flat are aligned.

red = 5 VDC ± 10%
white = output (see chart)
black = 0 VDC

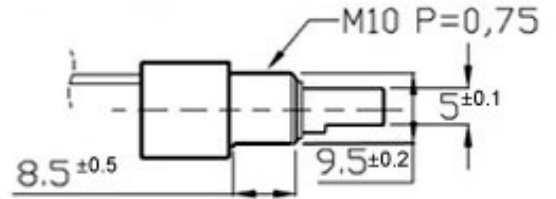
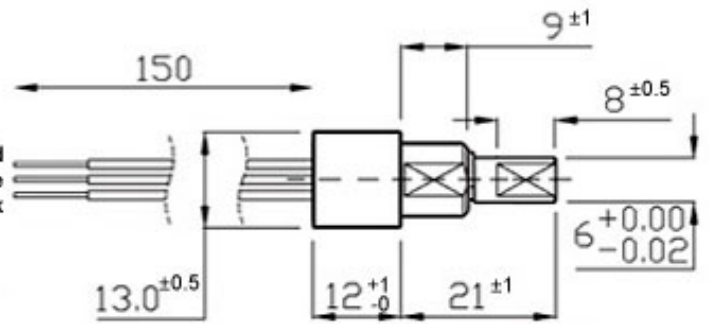

Options

- *Special Shaft Machining*

- *IP65 (sealed) Version*

- *Custom Cabling*

P3 America

3089C Clairemont Dr. #363 - San Diego, Ca. 92117

Phone: (858) 277-1420 Fax: (858) 225-0439

www.p3america.com

© P3 America 2004. All Rights Reserved