

Wire-Wound Element

Oil Filled - IP65

Heavy Duty



- 10 Million Cycles Life Span
- 100mm to 700mm Stroke Lengths
- High Precision

Specifically designed for operation in the worst environmental conditions such as salt, moisture, organic gas, etc. Element is hermetically sealed and bathed in a special mineral oil that contains no organic substances, such as PCB. Ideal for the marine industry, pits and mines, forestry machinery, chemical factories, etc.

Electrical Specifications	WGO 40100	WGO 40200	WGO 40300	WGO 40400	WGO 40500	WGO 40600	WGO 40700
Electrical Stroke (mm)	100	200	300	400	500	600	700
Resistance Value (Kohms)	0.5 - 20	0.1 - 50	0.2 - 50	1 - 50			
Resistance Tolerance	±5% (±3% opt.)						
Linearity Tolerance (std.)	±0.5%			±0.3%			
Linearity Tolerance (best)	±0.25%			±0.15%			
Max. Voltage (V)	300						
End Resistance	0.05%						
Power @ 40° (W)	1	1.5	3	1.5	3	5	6
Insulation Resistance	>100 Mohm @ 1000 VDC						
Dielectric Strength	1 minute @ 1000 VAC						
Noise	<100 ohm ENR						
Mechanical Specifications	WGO 40100	WGO 40200	WGO 40300	WGO 40400	WGO 40500	WGO 40600	WGO 40700
Mechanical Stroke (mm)	105	205	305	405	505	605	705
Maximum Operating Friction	20 (N)						
Stopper Strength	90 (N)						
Life Expectancy	10 million cycles						
Weight (g)	1000	1200	1500	1850	2250	2650	3100
Dimension A (±1mm)	267	367	467	567	667	767	867
Dimension B (±2mm)	328	428	528	628	728	828	928
Environmental Specifications							
Operating Temperature	-20°C to +60°C						
Storage Temperature	-50°C to +85°C						
IP Protection Grade	IP55						
Standard	per MIL-R-12934						
Materials							
Housing	Aluminum						
Shaft	Stainless steel						

Resist. Value (ohms)	Resolution (%)							Max. Current Through Element (mA)							Temp. Coefficient ppm/k	
	WGO 40100	WGO 40200	WGO 40300	WGO 40400	WGO 40500	WGO 40600	WGO 40700	WGO 40100	WGO 40200	WGO 40300	WGO 40400	WGO 40500	WGO 40600	WGO 40700		
50	0.240	-	-	-	-	-	-	-	-	-	-	-	-	-	-	80
100	0.190	0.120	0.14	-	-	-	-	-	-	-	-	-	-	-		
200	0.150	0.095	0.071	-	-	-	-	-	-	-	-	-	-	-		
500	0.110	0.071	0.053	0.047	-	-	-	-	-	-	-	-	-	-		
1k	0.125	0.055	0.042	0.037	0.032	0.027	0.023	55	70	83	-	-	-	-		
2k	0.100	0.062	0.045	0.036	0.031	0.026	0.020	38	50	59	-	-	-	-	20	
5k	0.071	0.045	0.033	0.029	0.026	0.023	0.019	24	31	37	42	46	49	50		
10k	0.059	0.035	0.026	0.024	0.022	0.020	0.018	17	22	26	29	31	33	34		
20k	0.045	0.029	0.021	0.019	0.017	0.016	0.016	12	16	18	20	22	24	26		
50k	-	0.020	0.016	0.014	0.013	0.013	0.013	-	10	12	14	16	17	18		

Dimensions: mm

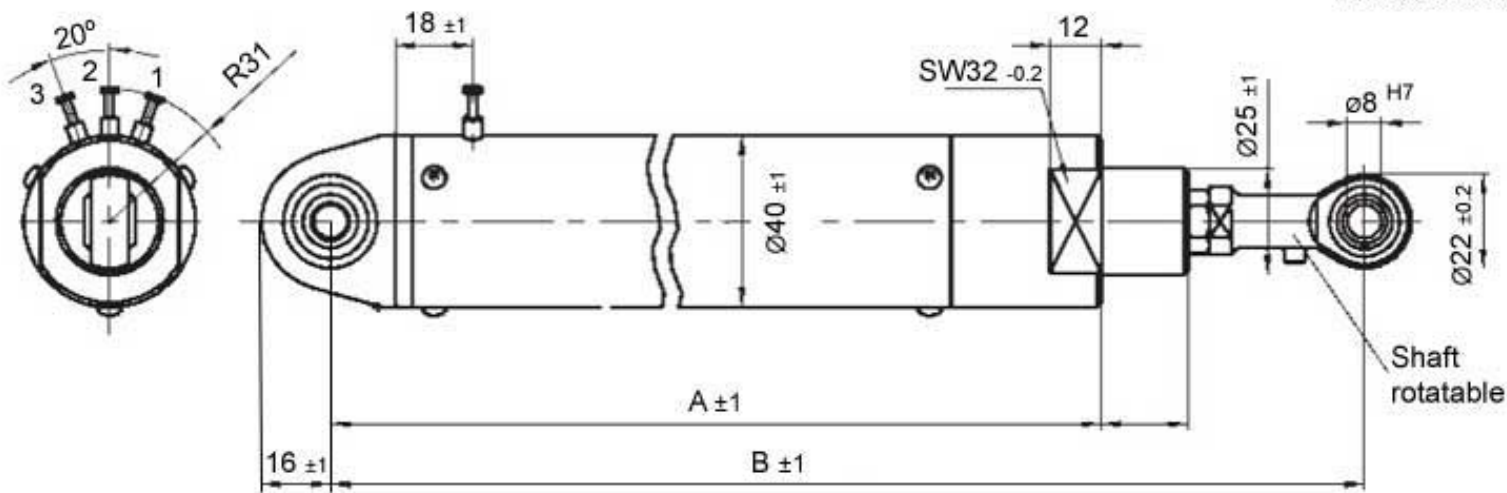

Cable Version 'K'

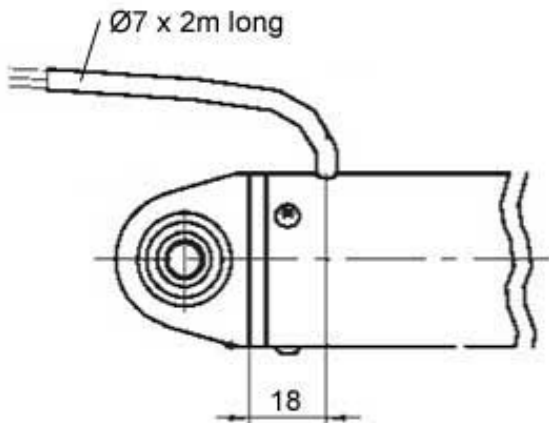

Connector Version 'ST'

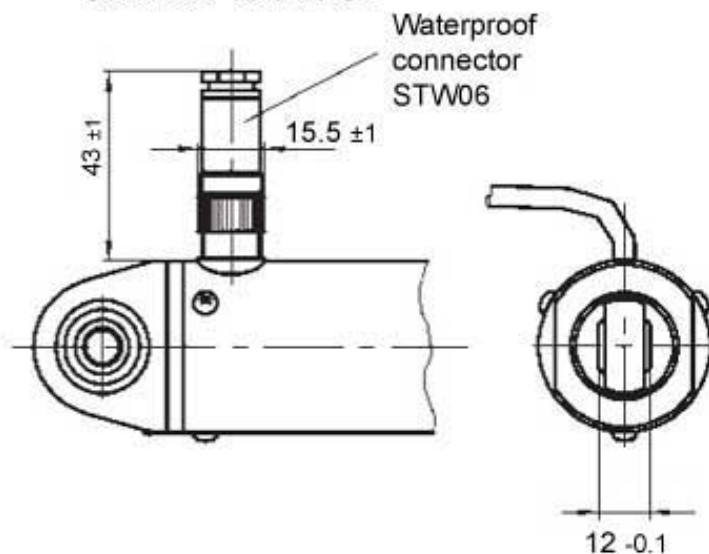

Accessories

Waterproof connector for wire diameters of Ø6.3mm max.

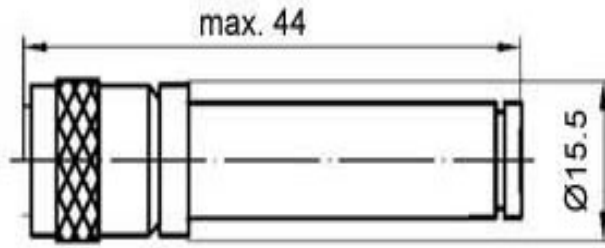

P3 America - 3089C Clairemont Dr. #363 - San Diego, Ca. 92117

P:(858) 277-1420 F: (858) 225-0439 - www.p3america.com

© P3 America 2004. All Rights Reserved